

REMOVAL

1. DRAIN ENGINE COOLANT FROM RADIATOR

HINT:

It is not necessary to drain out all the coolant.

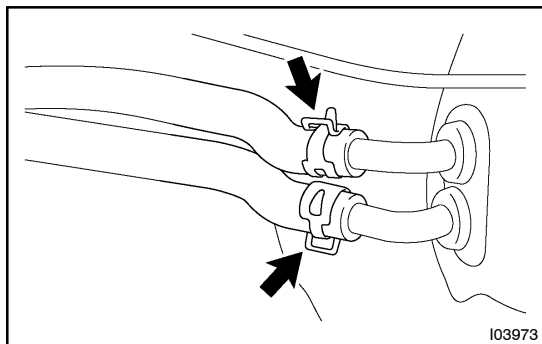

2. DISCONNECT WATER HOSES FROM HEATER RADIATOR PIPES

- (a) Using pliers, grip the claws of the clip and slide the clip along the hose
- (b) Disconnect the water hoses

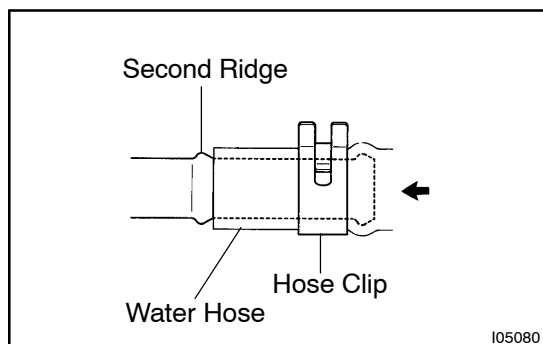

HINT:

At the time of installation, please refer to the following item.

Push the water hose on to the heater radiator pipe as far as the second ridge on the pipe.

3. REMOVE FRONT SEATS
4. REMOVE REAR CONSOLE BOX
5. REMOVE FRONT CONSOLE BOX COVER
6. REMOVE LOWER CENTER CLUSTER FINISH PANEL
7. REMOVE FRONT DOOR SCUFF PLATE
8. REMOVE COWL SIDE TRIMS
9. REMOVE REAR DOOR SCUFF PLATES
10. REMOVE CENTER PILLAR GARNISHES
11. SLIDE FLOOR CARPET BACKWARD

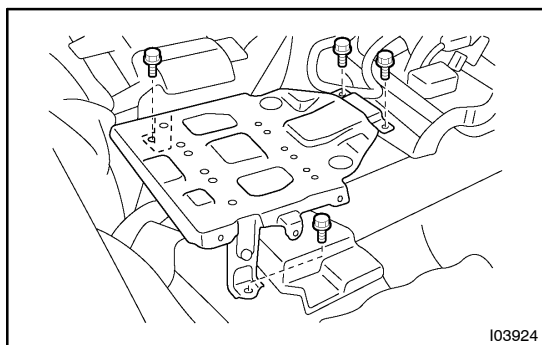

12. REMOVE COOLER BRACKET

Remove the 4 bolts and cooler bracket.

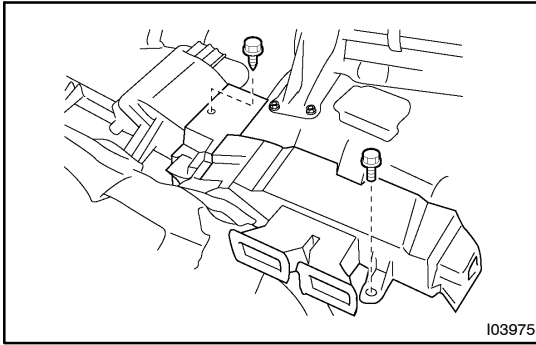
**13. REMOVE REAR HEATER DUCT**

Remove the bolt, screw and rear heater duct.

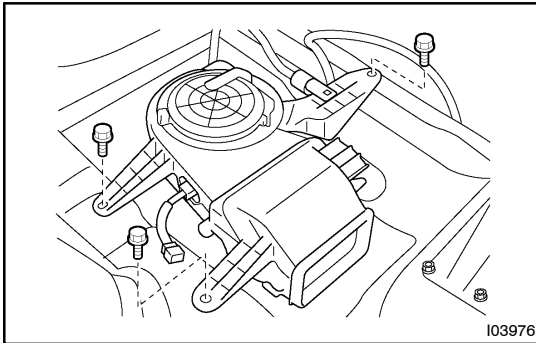
**14. REMOVE REAR HEATER UNIT**

- (a) Disconnect the connector.
- (b) Remove the 3 bolts and rear heater unit.